

MANDÍK[®]

INSTALLATION INSTRUCTIONS MOUNTING FRAME R1-R7 ON FIRE DAMPER

FDMR

Mounting frame R1

Set includes:

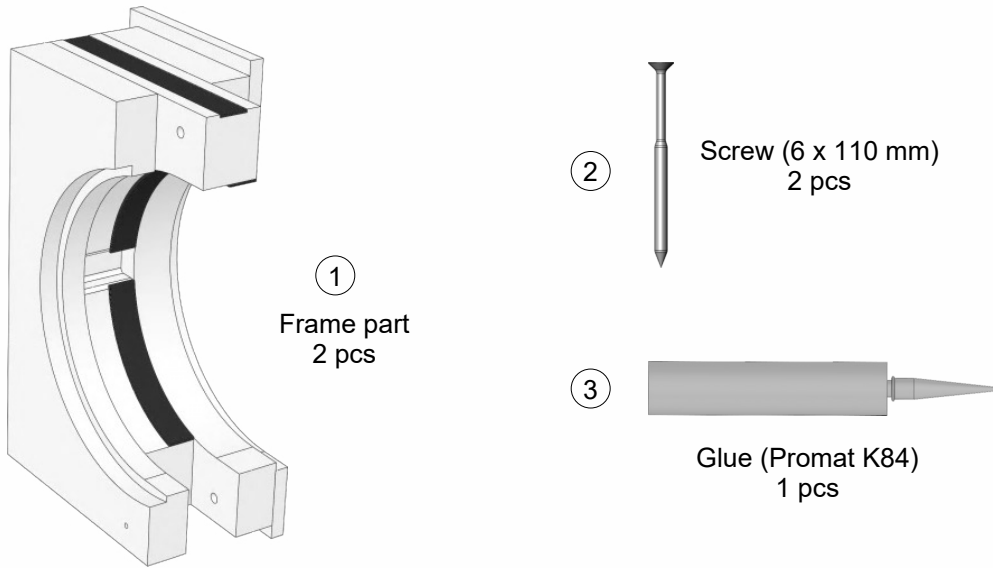

Exploded view of assembly:

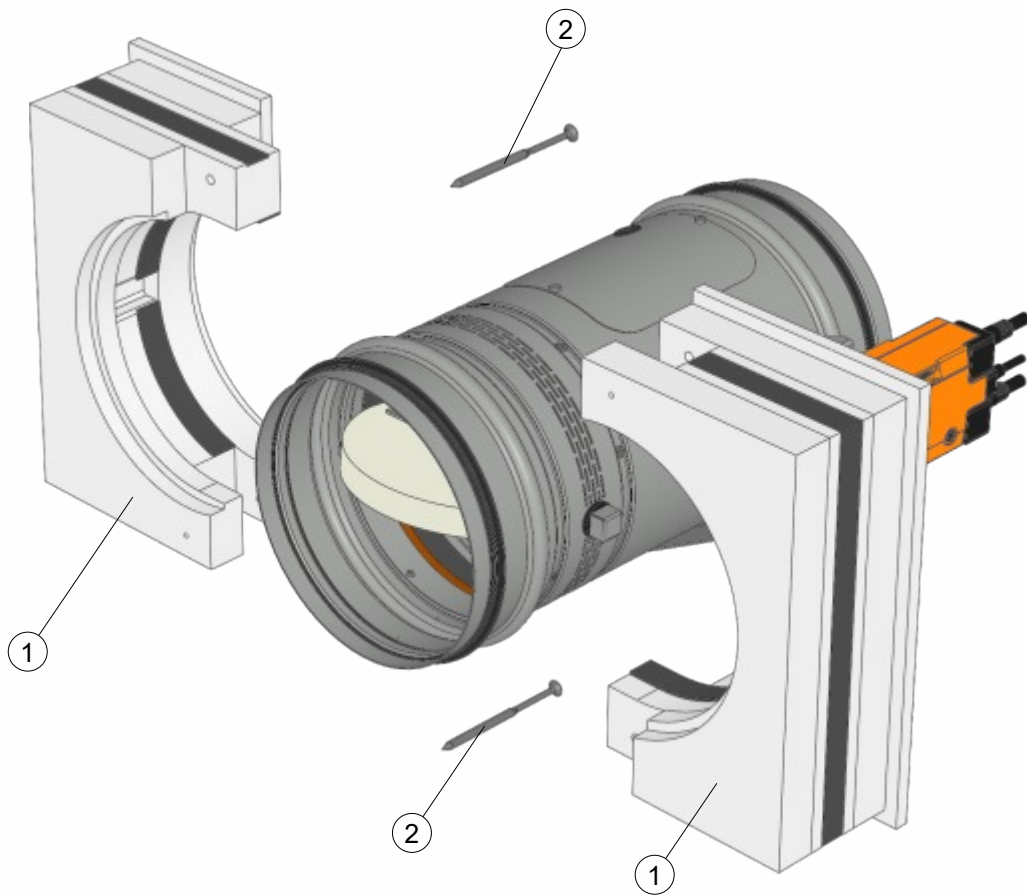

Note: The damper frame DN 710 and DN 800 consists of 4 parts !

Mounting frame R1

Assembly procedure:

1) Apply glue to the fire damper. The glue is applied with a perforation width of +5 mm.

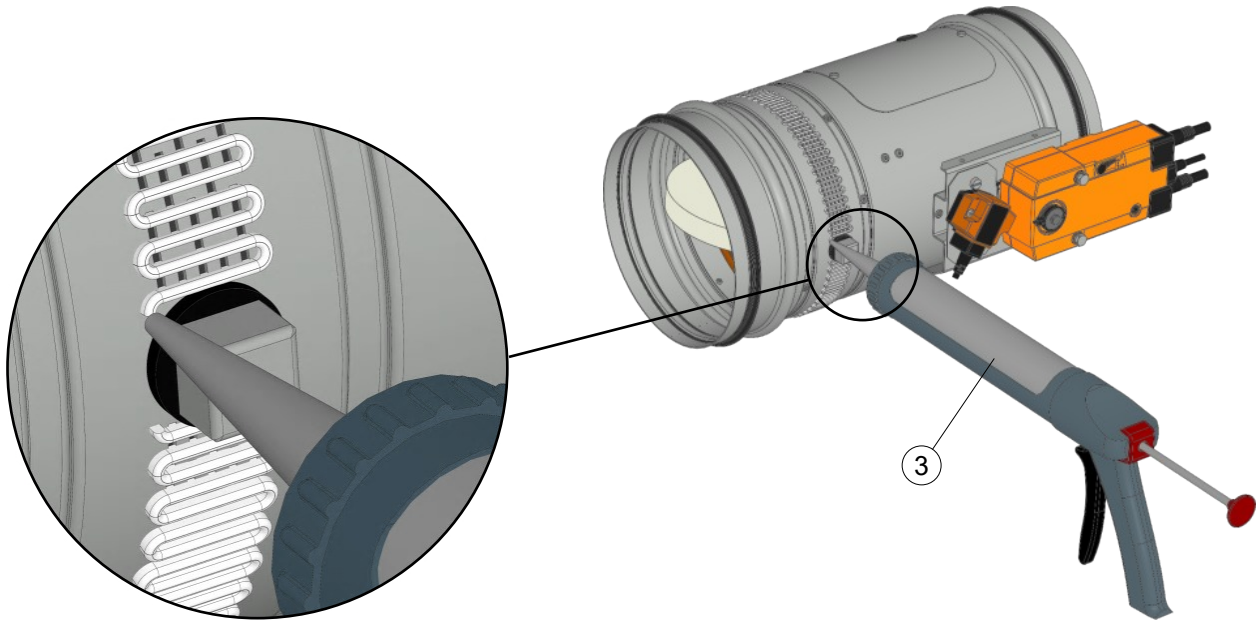

2) Place both frame parts on the fire damper body and fasten with two M6 x 110 mm screws.

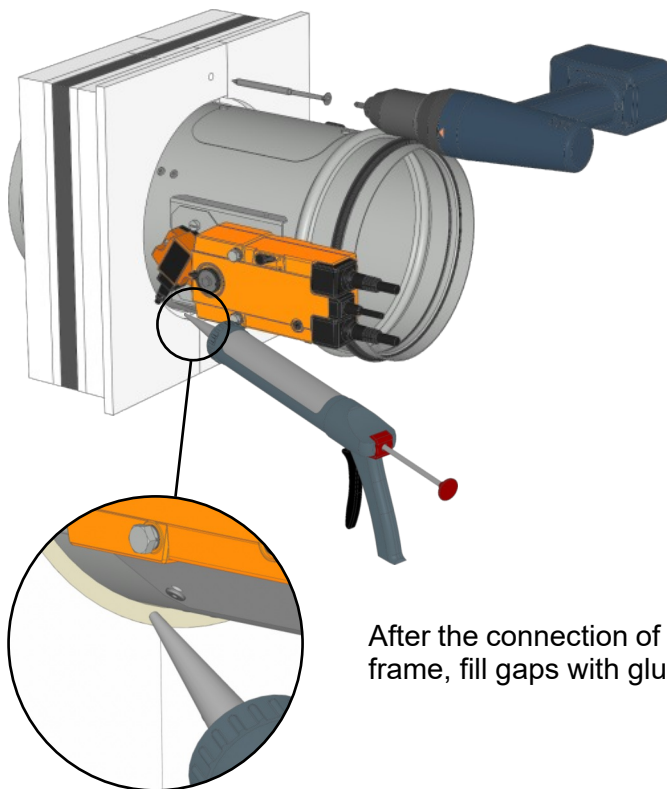

After the connection of the frame, fill gaps with glue.

Frame position on the damper

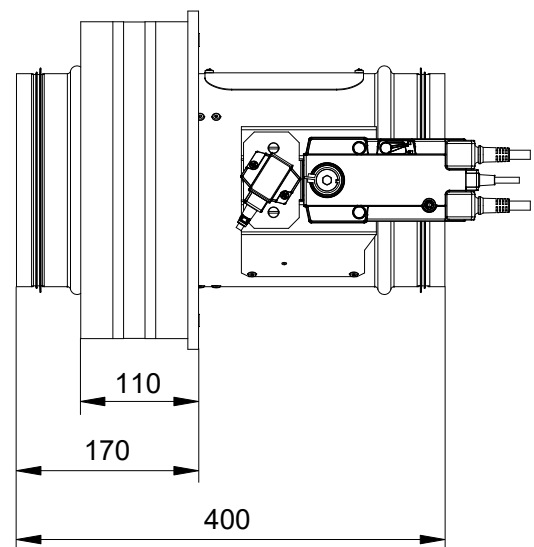

Note: The glue cures at 20°C after 12 hours. After this time, the fire damper with the mounting frame is ready for installation.

Mounting frame R2

Set includes:

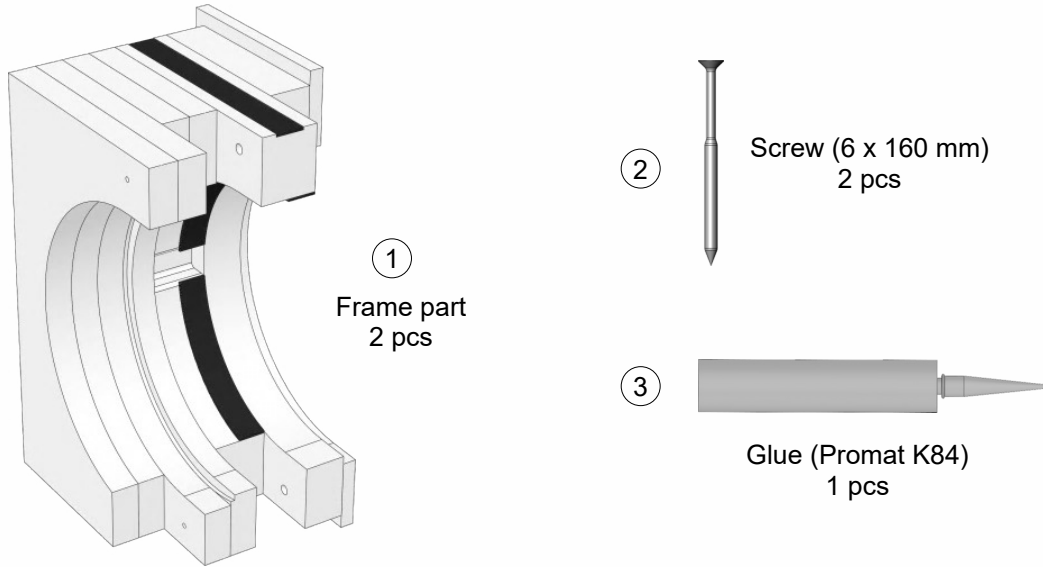

Exploded view of assembly:

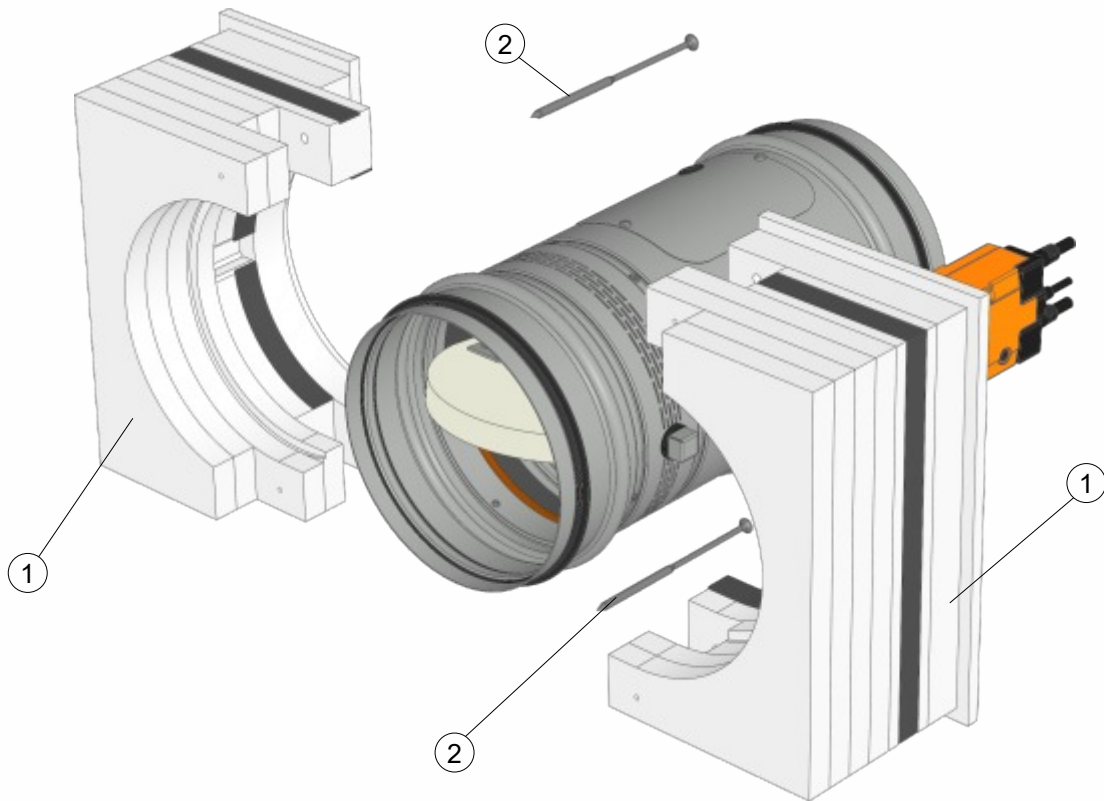

Note: The damper frame DN 710 and DN 800 consists of 4 parts !

Mounting frame R2

Assembly procedure:

1) Apply glue to the fire damper. The glue is applied with a perforation width of +5 mm.

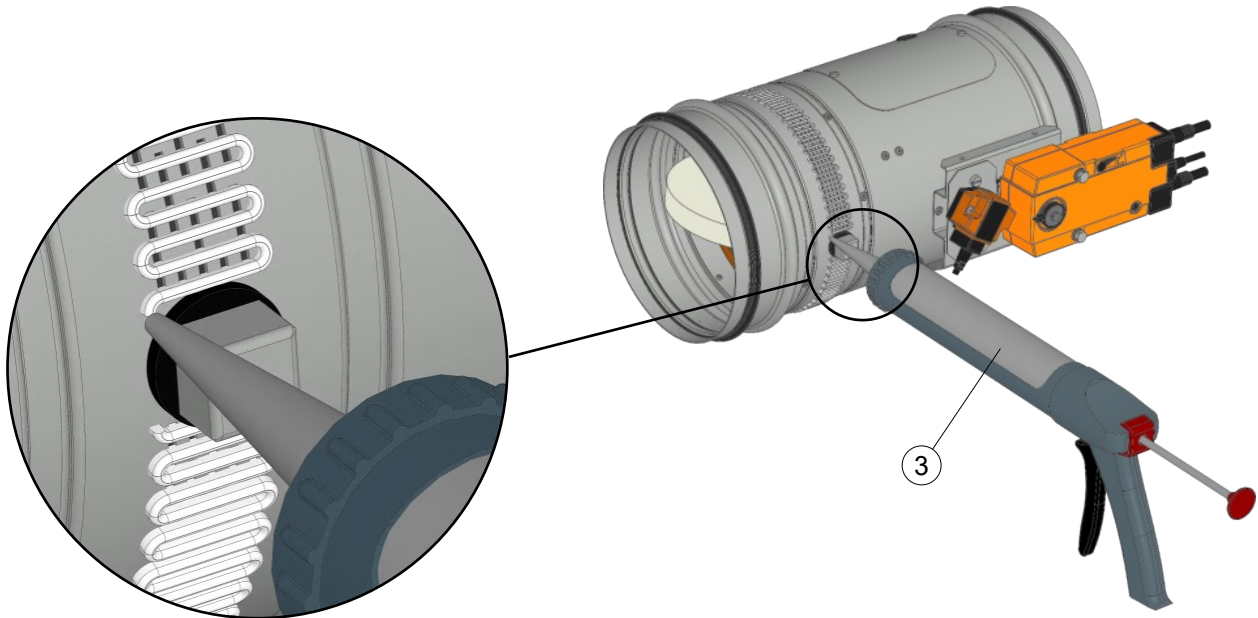

2) Place both frame parts on the fire damper body and fasten with two M6 x 160 mm screws.

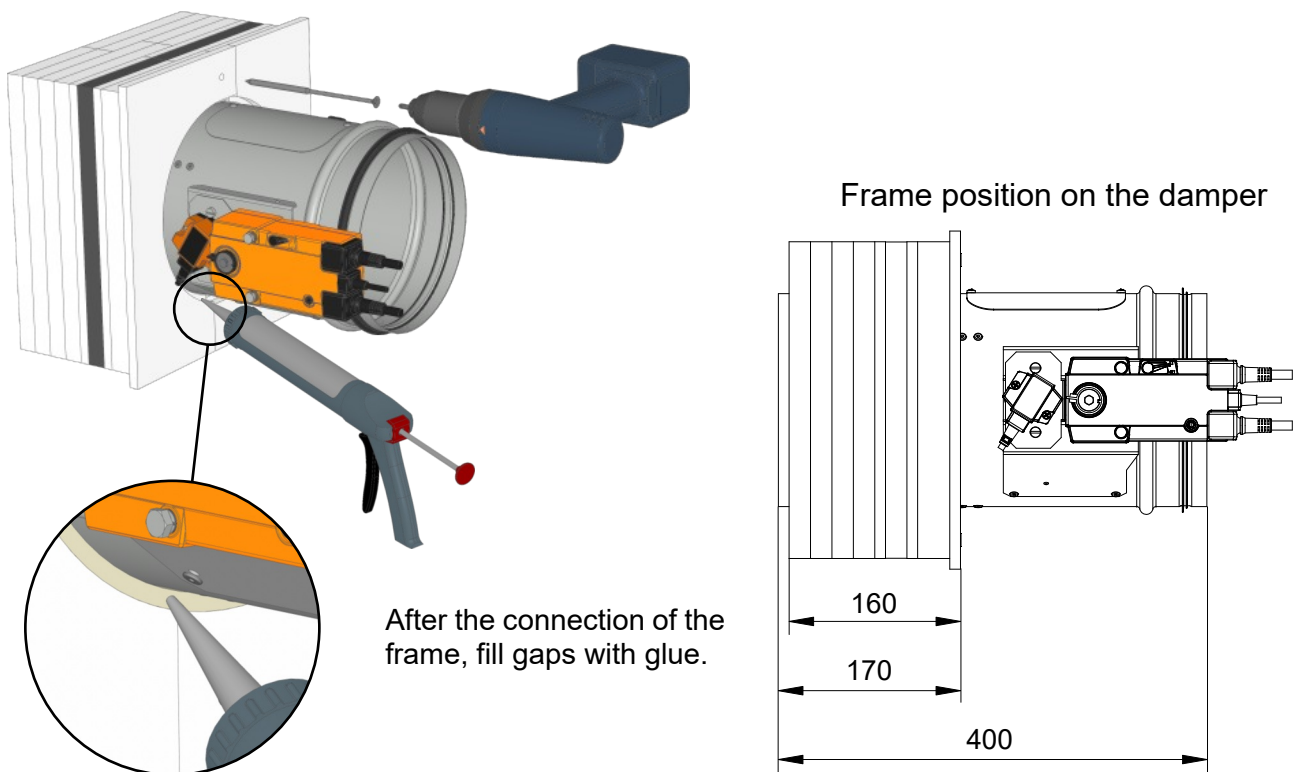

Note: The glue cures at 20°C after 12 hours. After this time, the fire damper with the mounting frame is ready for installation.

Mounting frame R3

Set includes:

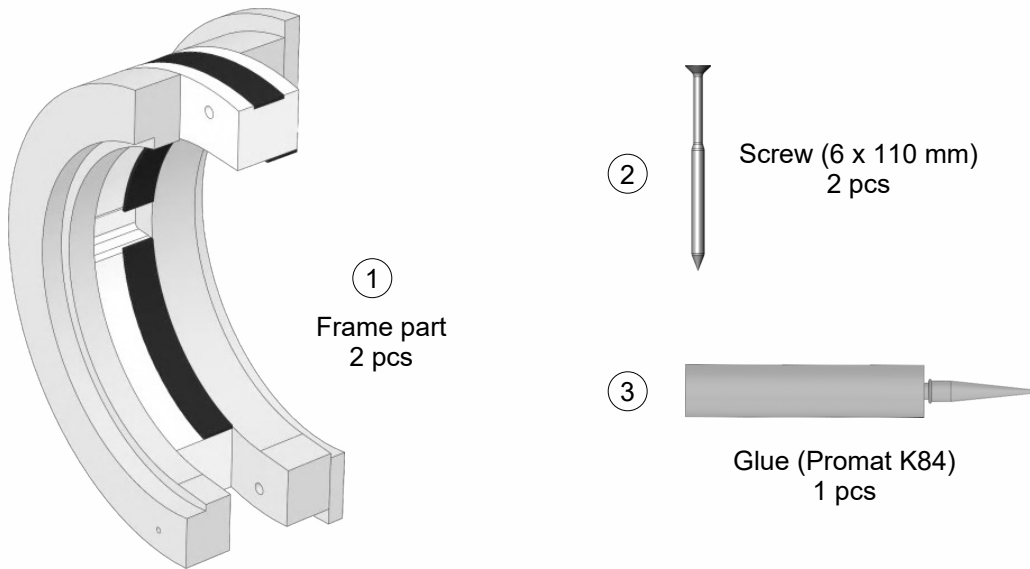

Exploded view of assembly:

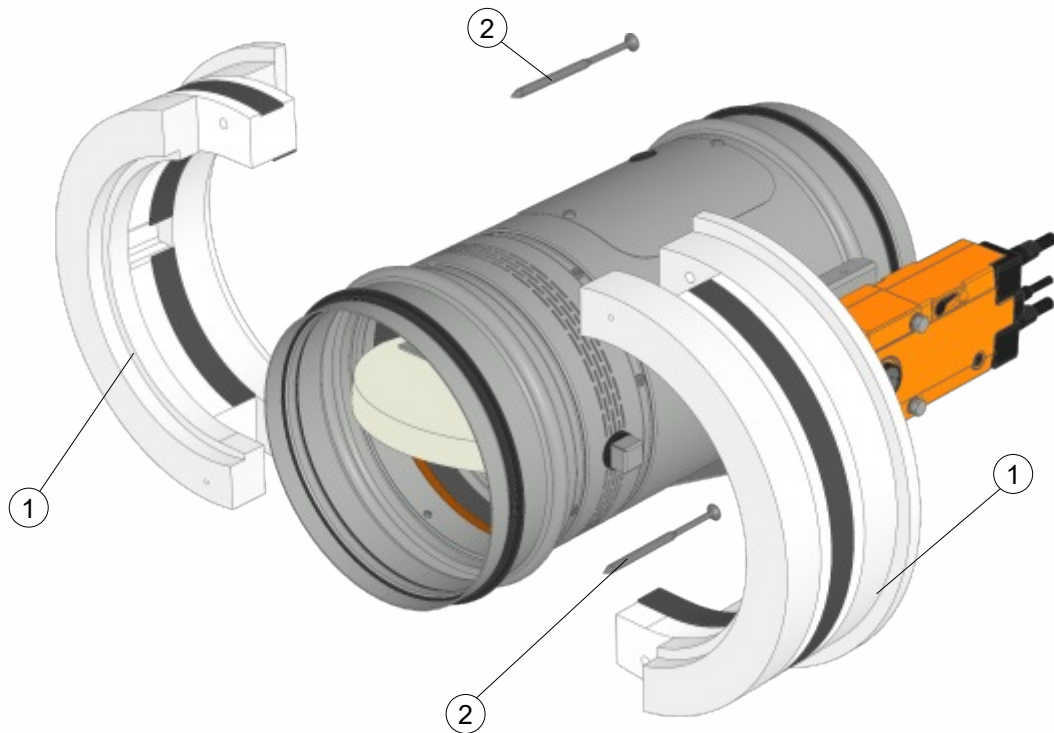

Note: The damper frame DN 710 and DN 800 consists of 4 parts !

Mounting frame R3

Assembly procedure:

1) Apply glue to the fire damper. The glue is applied with a perforation width of +5 mm.

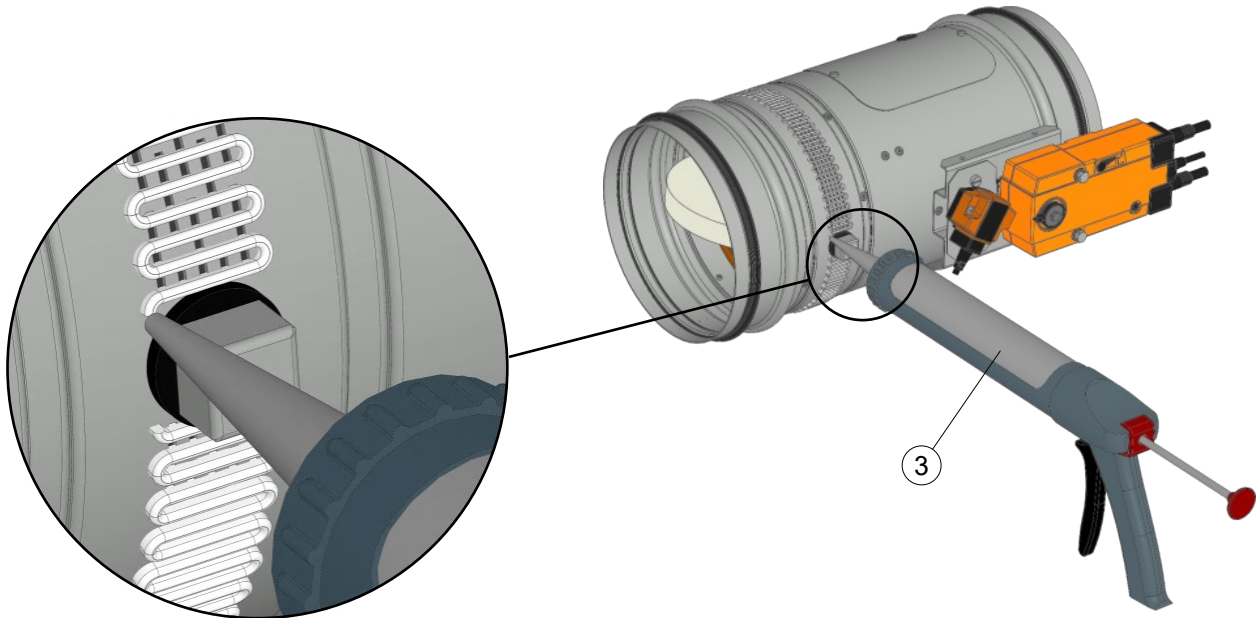

2) Place both frame parts on the fire damper body and fasten with two M6 x 110 mm screws.

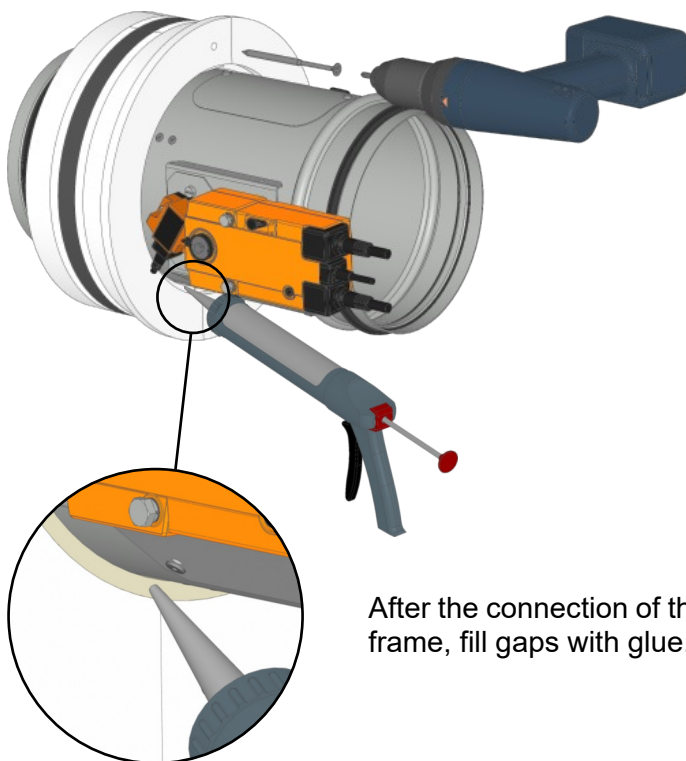

After the connection of the frame, fill gaps with glue.

Frame position on the damper

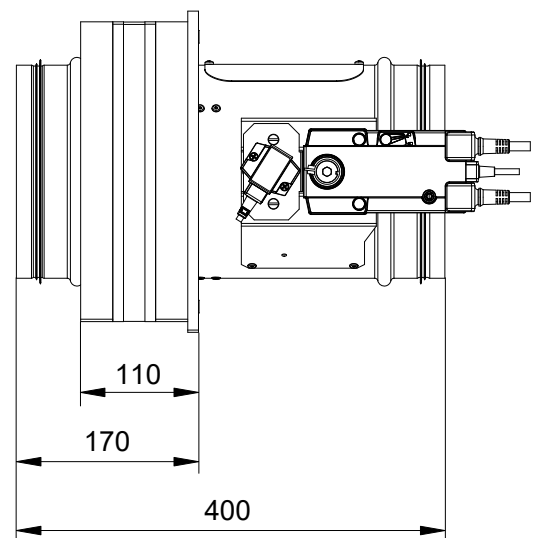

Note: The glue cures at 20°C after 12 hours. After this time, the fire damper with the mounting frame is ready for installation.

Mounting frame R4

Set includes:

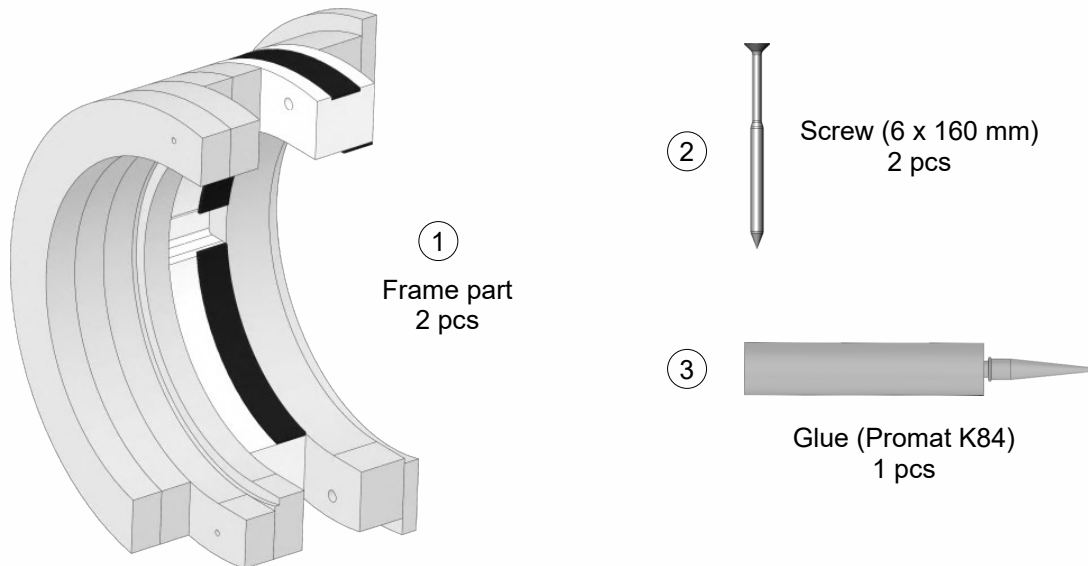

Exploded view of assembly:

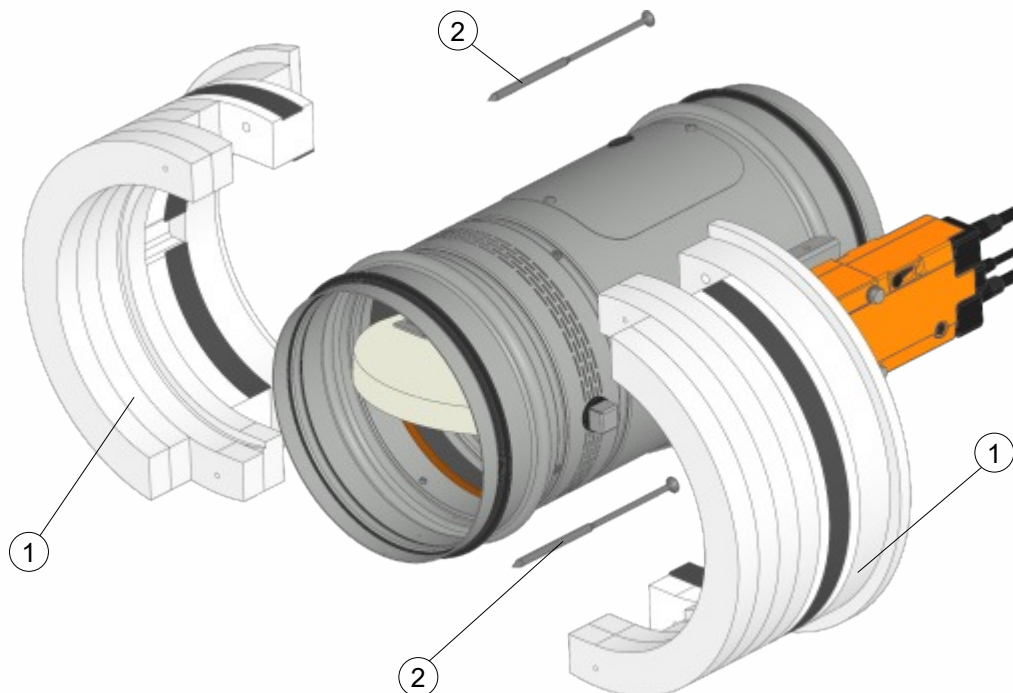

Note: The damper frame DN 710 and DN 800 consists of 4 parts !

Mounting frame R4

Assembly procedure:

1) Apply glue to the fire damper. The glue is applied with a perforation width of +5 mm.

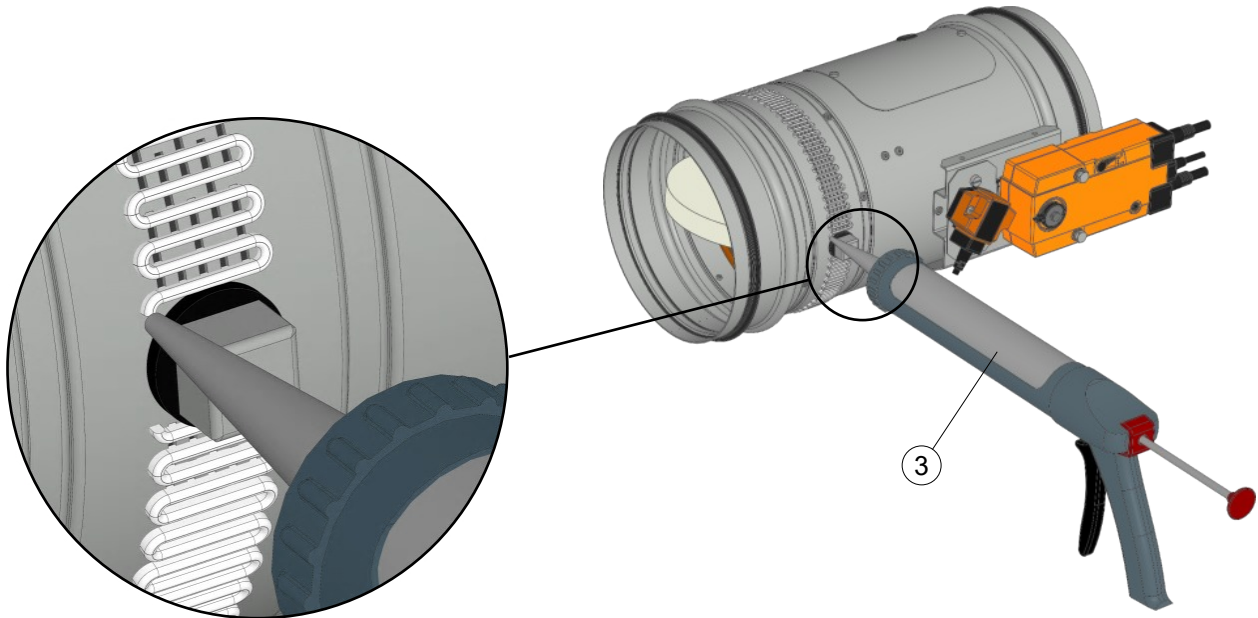

2) Place both frame parts on the fire damper body and fasten with two M6 x 160 mm screws.

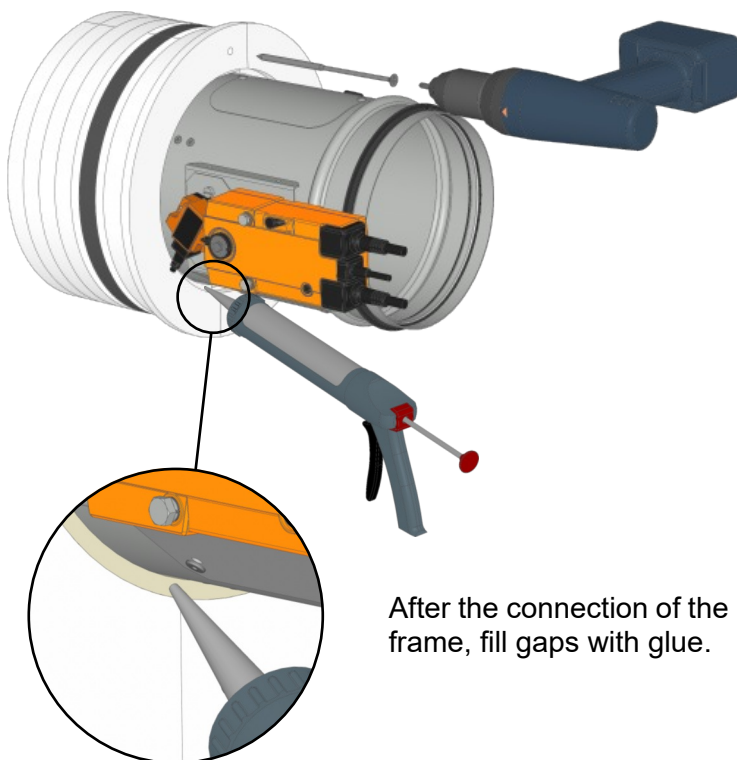

After the connection of the frame, fill gaps with glue.

Frame position on the damper

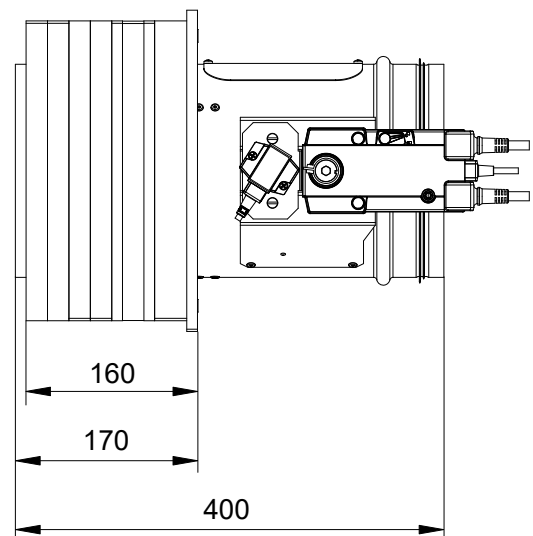

Note: The glue cures at 20°C after 12 hours. After this time, the fire damper with the mounting frame is ready for installation.

Mounting frame R5 (DN 100 - 200)

Set includes:

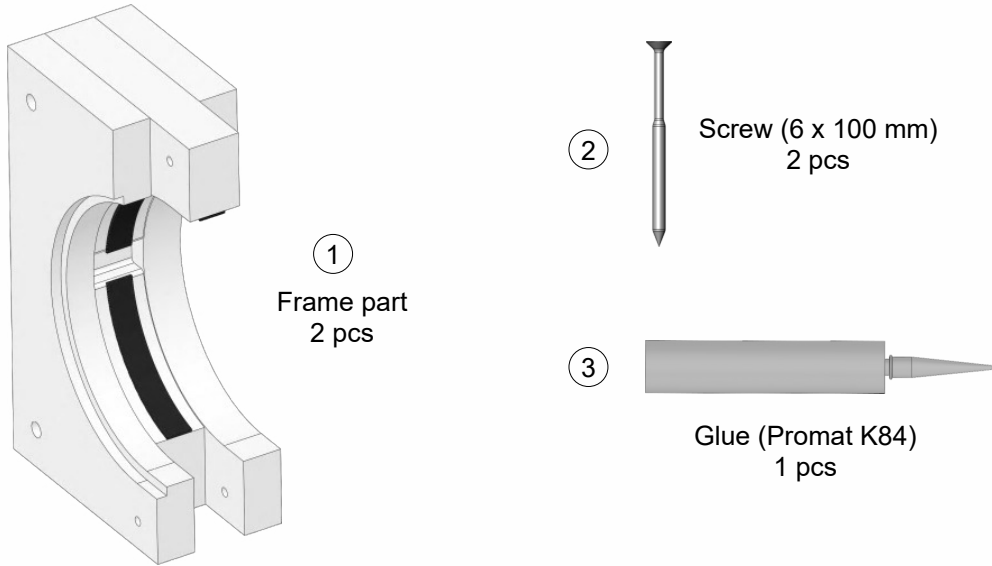

Exploded view of assembly:

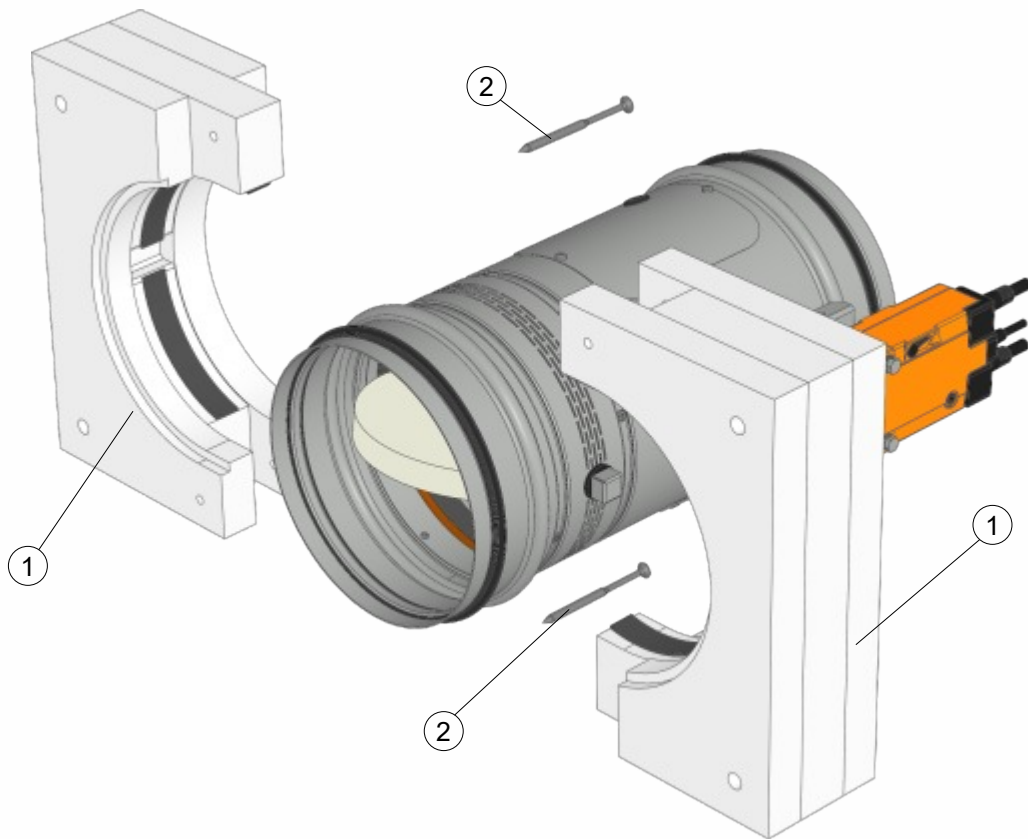

Note: The damper frame DN 710 and DN 800 consists of 4 parts !

Mounting frame R5 (DN 100 - 200)

Assembly procedure:

1) Apply glue to the fire damper. The glue is applied with a perforation width of +5 mm.

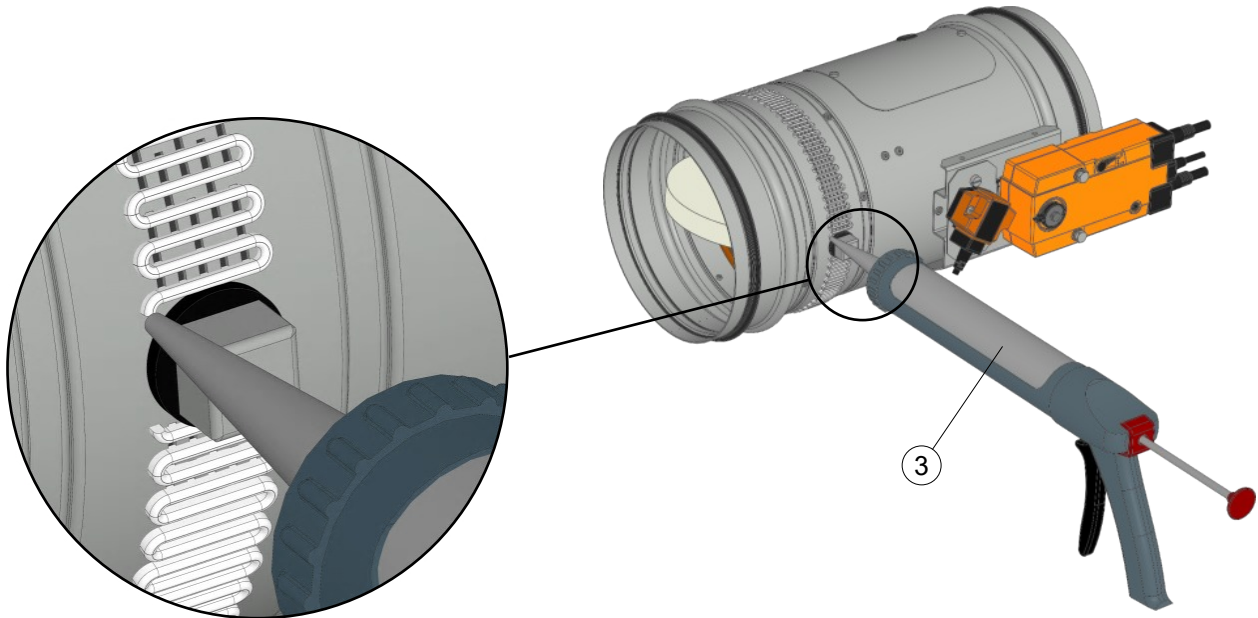

2) Place both frame parts on the fire damper body and fasten with two M6 x 100 mm screws.

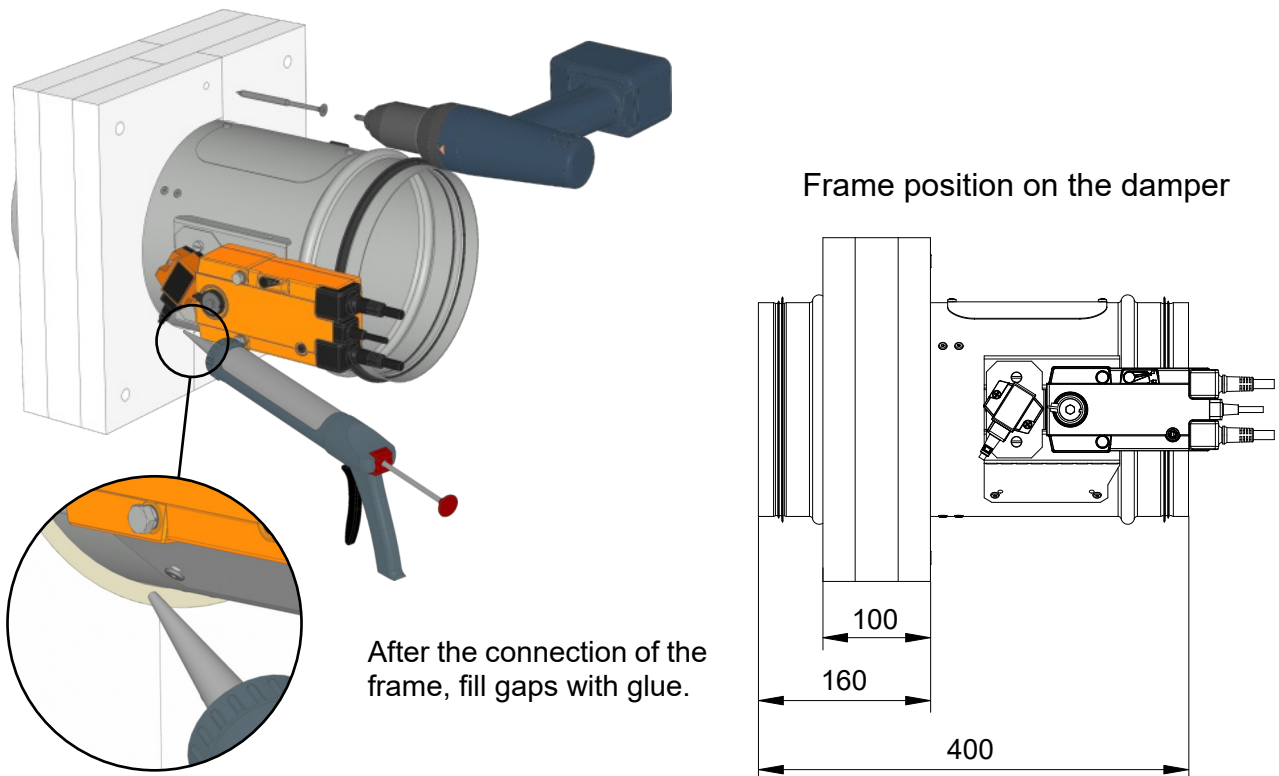

Note: The glue cures at 20°C after 12 hours. After this time, the fire damper with the mounting frame is ready for installation.

Mounting frame R5 (DN 225 - 800)

Set includes:

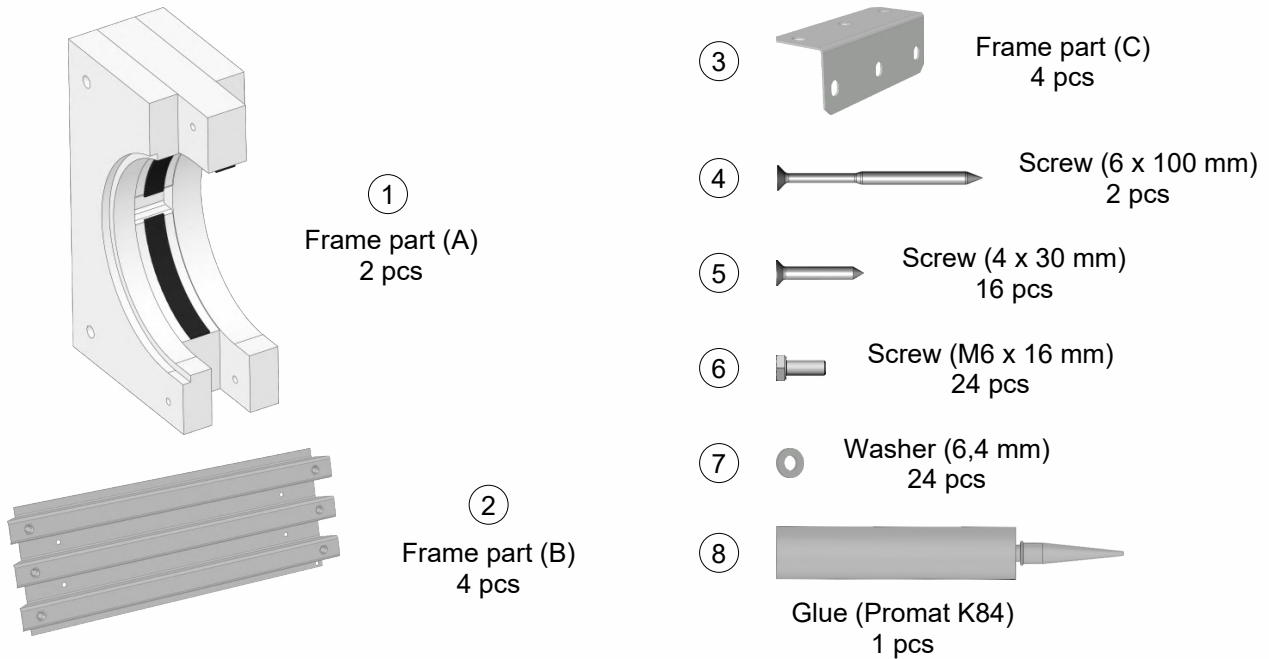

Exploded view of assembly:

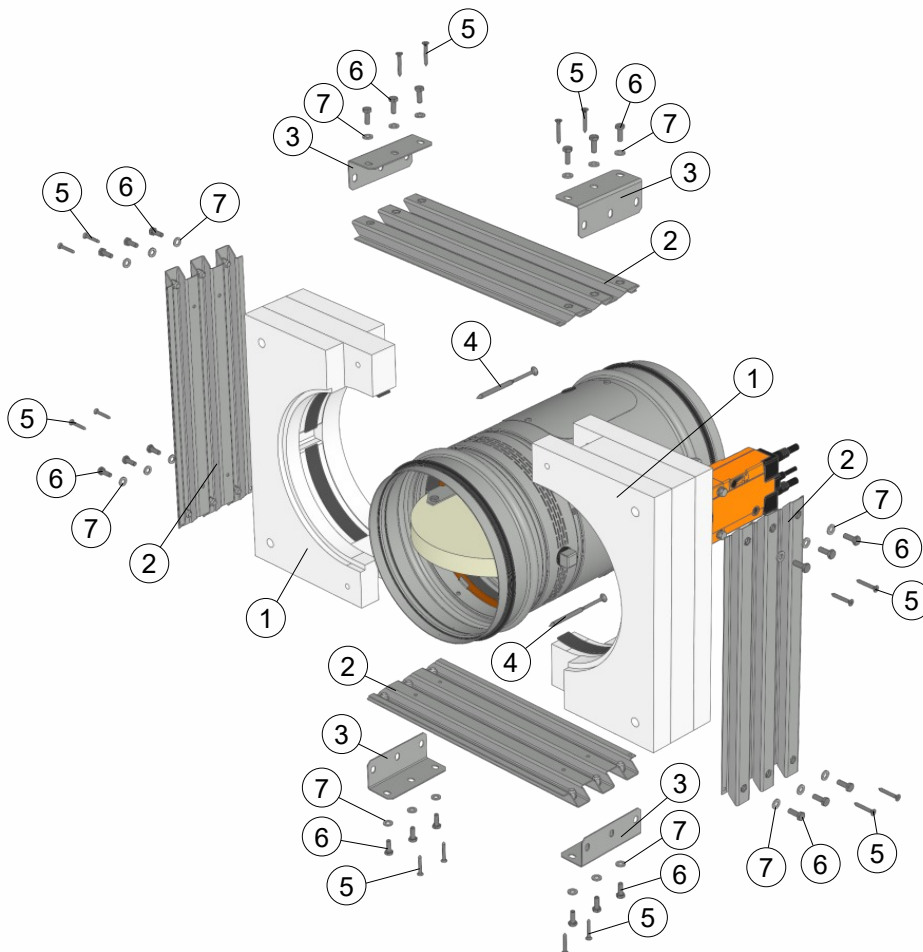

Note: The frame part (A) for the damper DN 710 and DN 800 consists of 4 parts !

Mounting frame R5 (DN 225 - 800)

Assembly procedure:

- 1) Apply glue to the fire damper. The glue is applied with a perforation width of +5 mm.

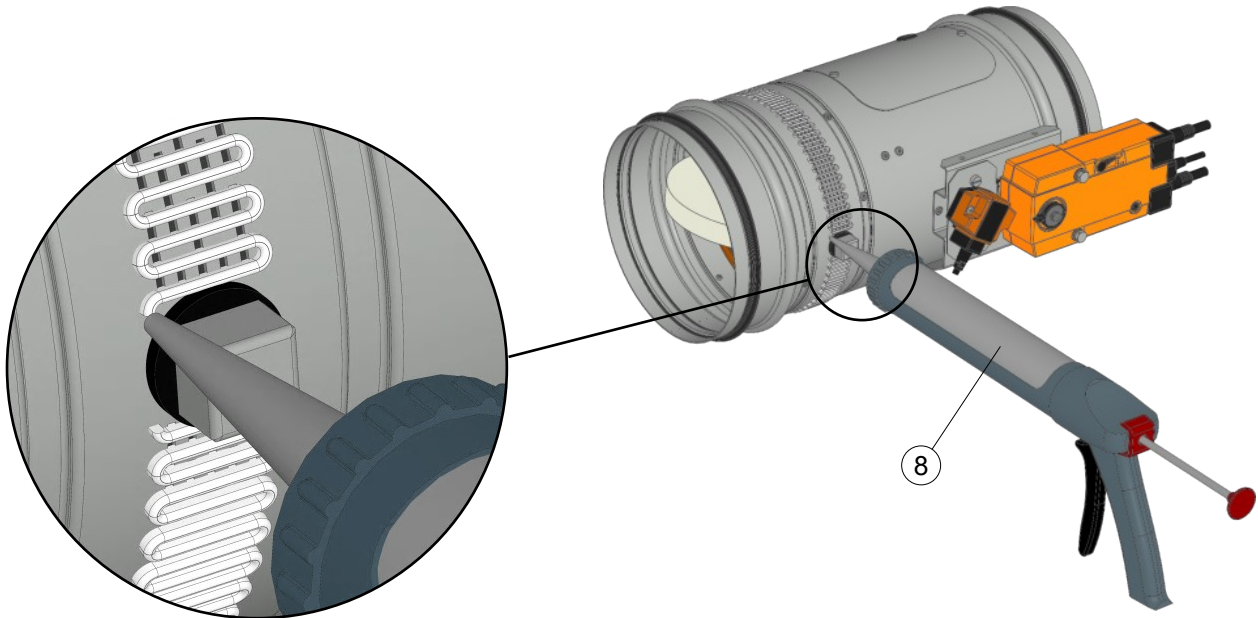

- 2) Place both frame parts (A) on the fire damper body and fasten with two M6 x 100-mm screws.
Place the frame parts (B) and (C) on the frame (A) and fasten with M6 x 16 mm screws and 4 x 30 screws.

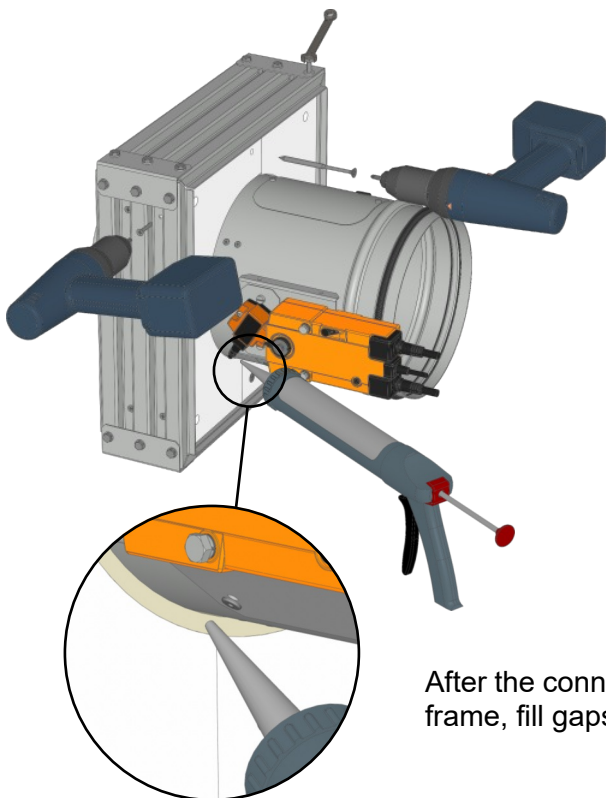

After the connection of the frame, fill gaps with glue.

Frame position on the damper

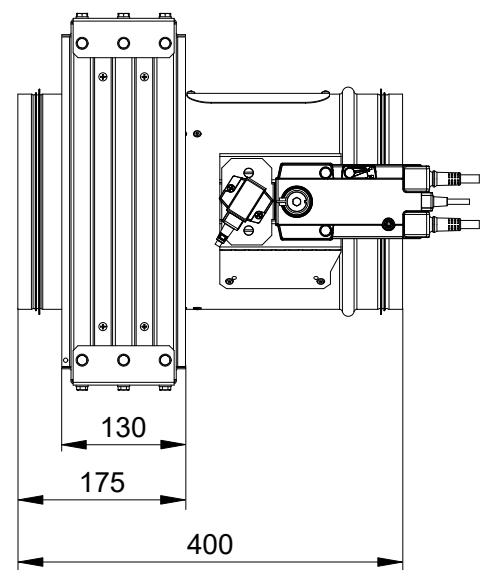

Note: The glue cures at 20°C after 12 hours. After this time, the fire damper with the mounting frame is ready for installation.

Mounting frame R6

Set includes:

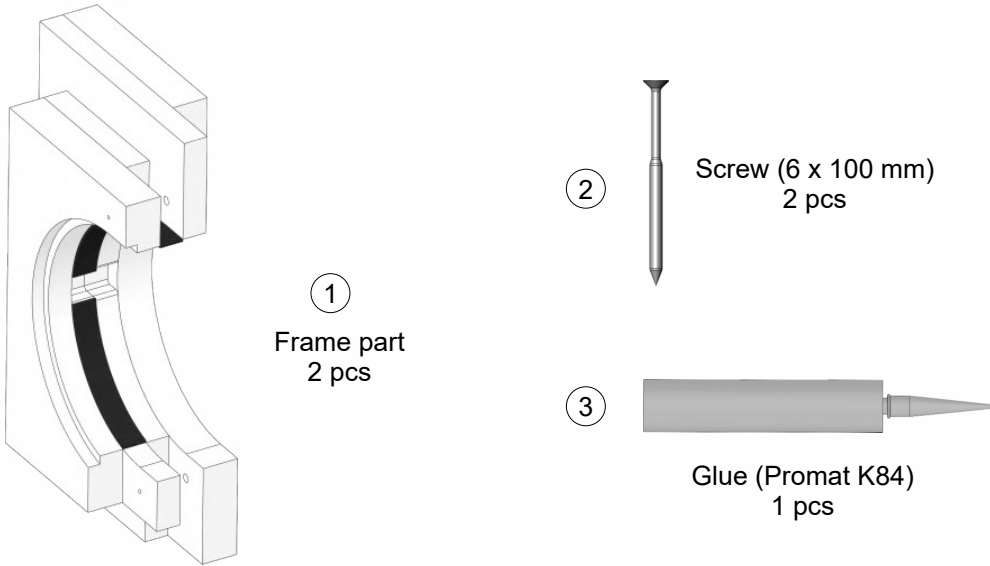

Exploded view of assembly:

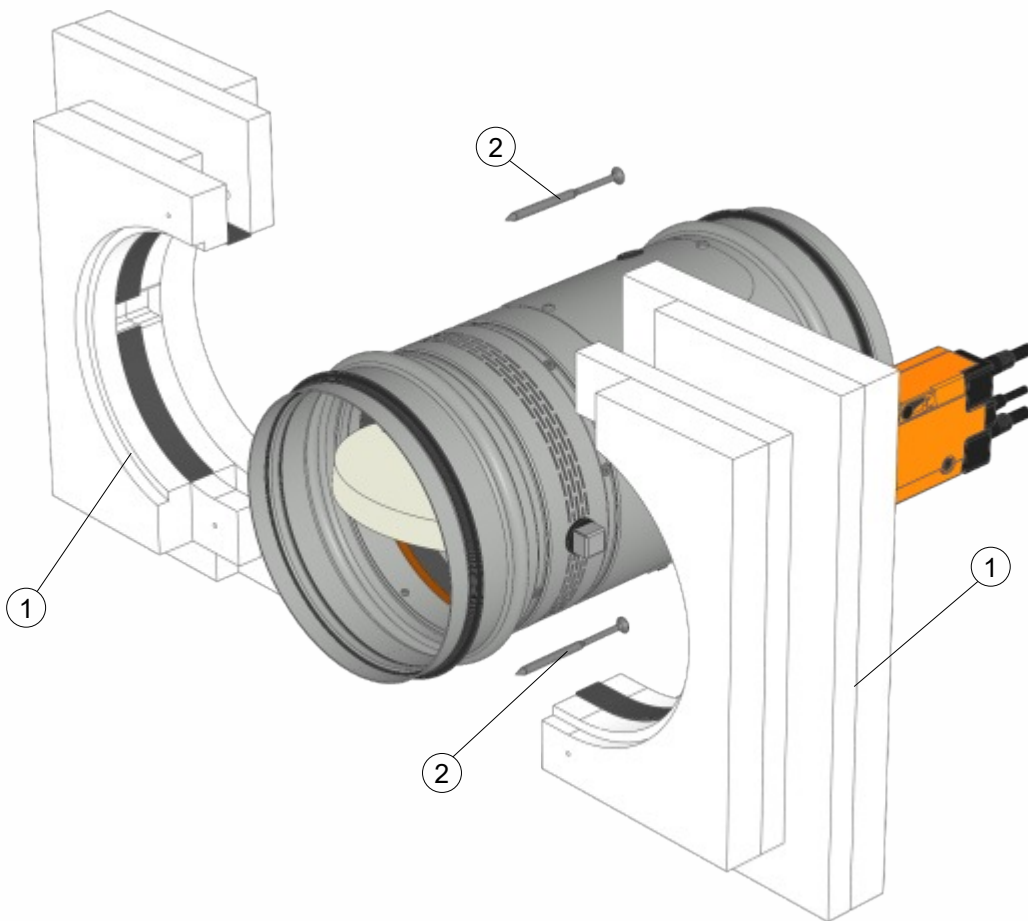

Note: The damper frame DN 710 and DN 800 consists of 4 parts !

Mounting frame R6

Assembly procedure:

1) Apply glue to the fire damper. The glue is applied with a perforation width of +5 mm.

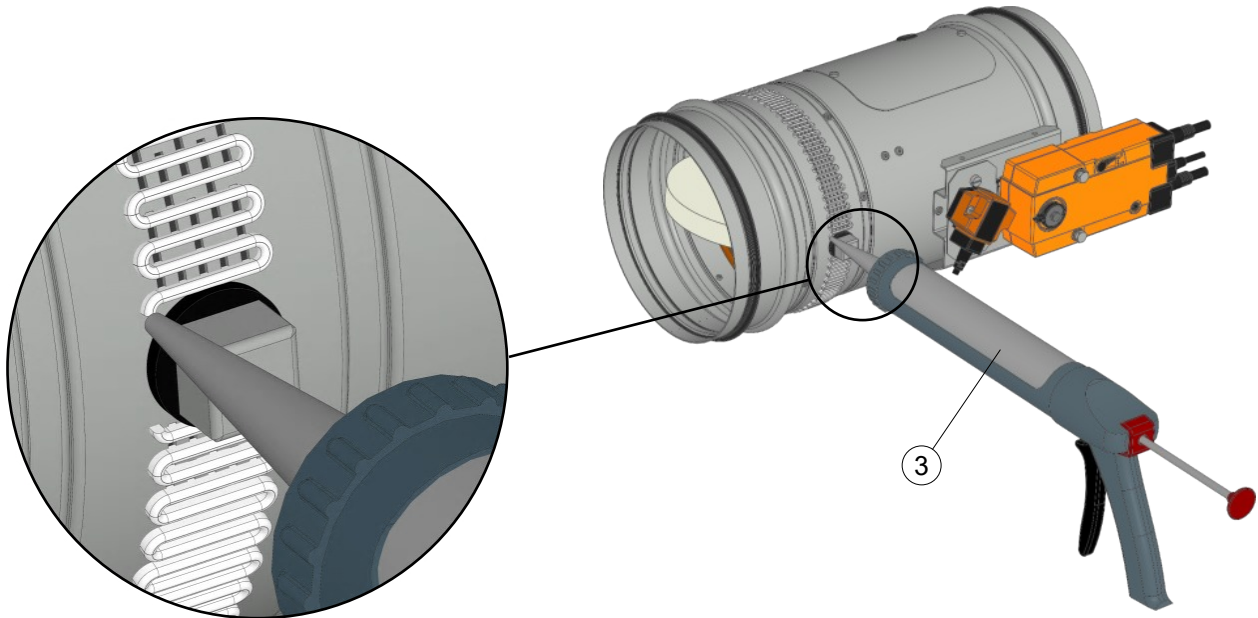

2) Place both frame parts on the fire damper body and fasten with two M6 x 100 mm screws.

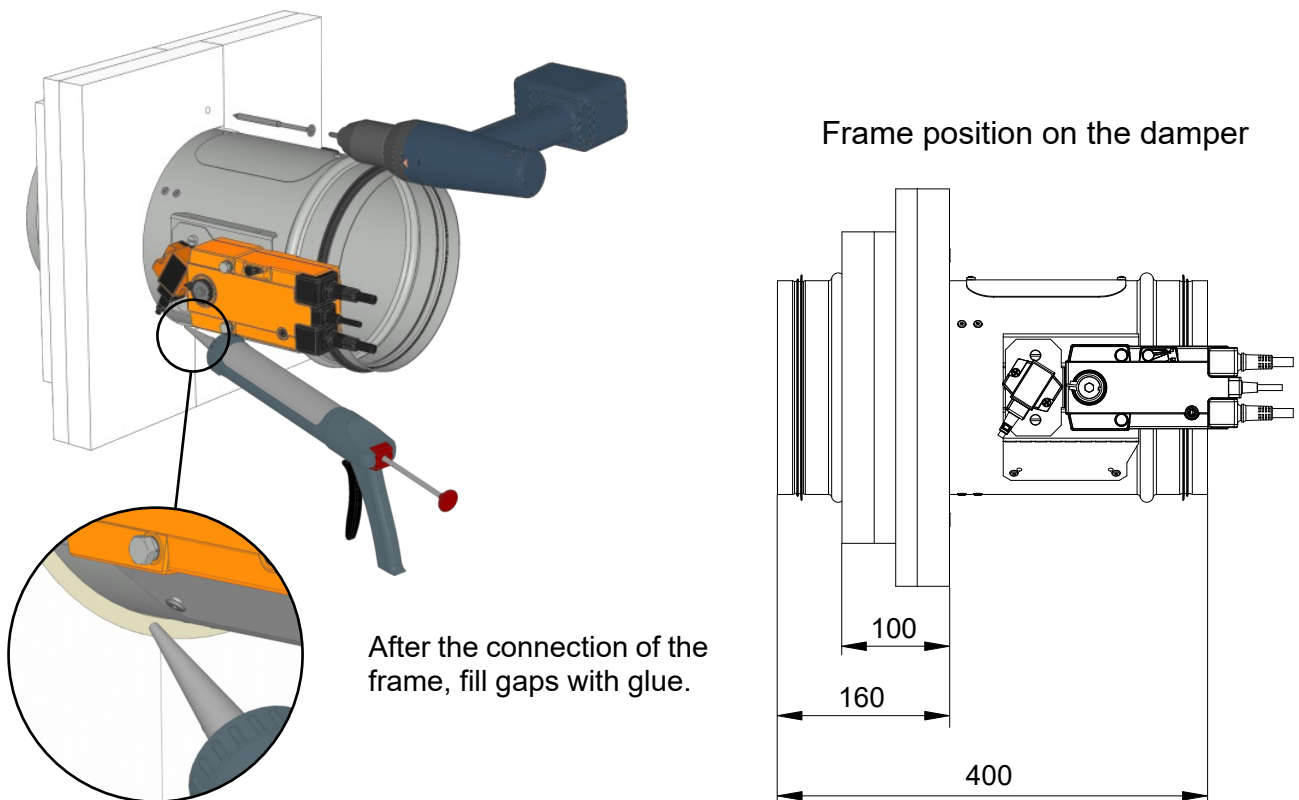

Note: The glue cures at 20°C after 12 hours. After this time, the fire damper with the mounting frame is ready for installation.

Mounting frame R7

Set includes:

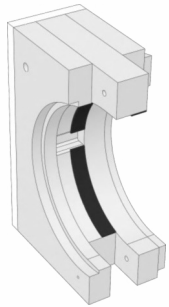

①
Frame part (A)
1 pcs

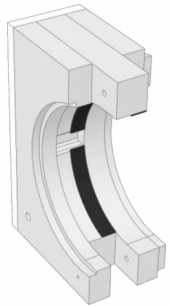

②
Frame part (B)
1 pcs

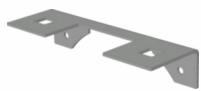

③
Frame holder
2 pcs

- ④ Reinforcing plate DN+156 mm - 2 pcs
- ⑤ Promatect-H DN+176 mm - 2 pcs
- ⑥ Promatect-H DN+206 mm - 2 pcs
- ⑦ Promatect-H DN+170 mm - 1 pcs
- ⑧ Reinforcing plate DN+170 mm - 1 pcs
- ⑨ Promatect-H DN+172 mm - 1 pcs
- ⑩ Promatect-H DN+212 mm - 1 pcs
- ⑪ Promaseal PL 1,8
- ⑫ Screw (6 x 100 mm) - 11 pcs
- ⑬ Screw (6 x 60 mm) - 2 pcs
- ⑭ Screw (M10 x 120 mm) - 2 pcs
- ⑮ Nut (M10) - 2 pcs
- ⑯ Glue (Promat K84) - 1 pcs

Exploded view of assembly:

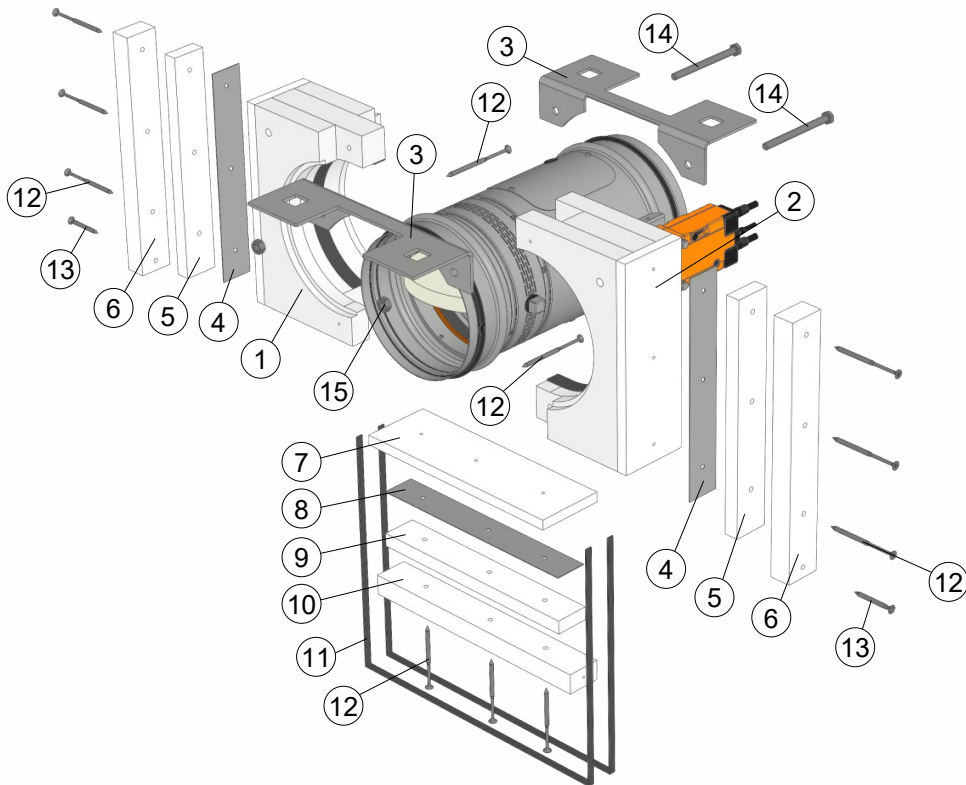

Note: Frame parts (A) and (B) for damper DN 710 and DN 800 are composed of 4 parts !

Mounting frame R7

Assembly procedure:

- 1) Apply glue to the fire damper. The glue is applied with a perforation width of +5 mm.

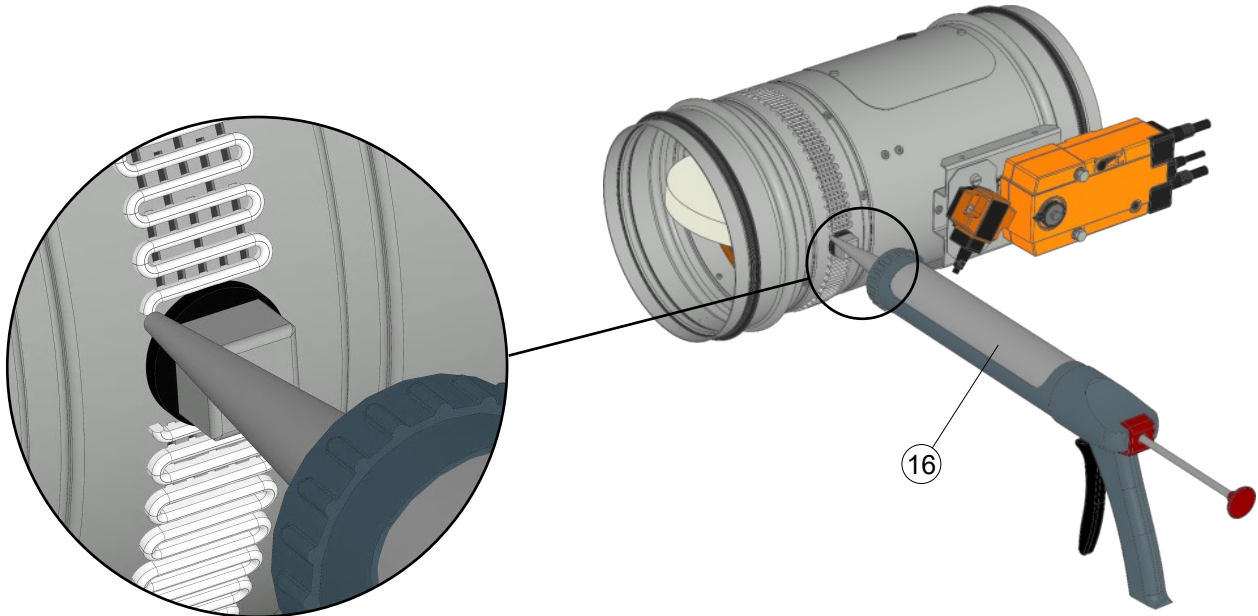

- 2) Place the frame parts on the fire damper body as shown in the exploded view. Fasten the screws into the pre-drilled holes and glue the PROMASEAL tape.

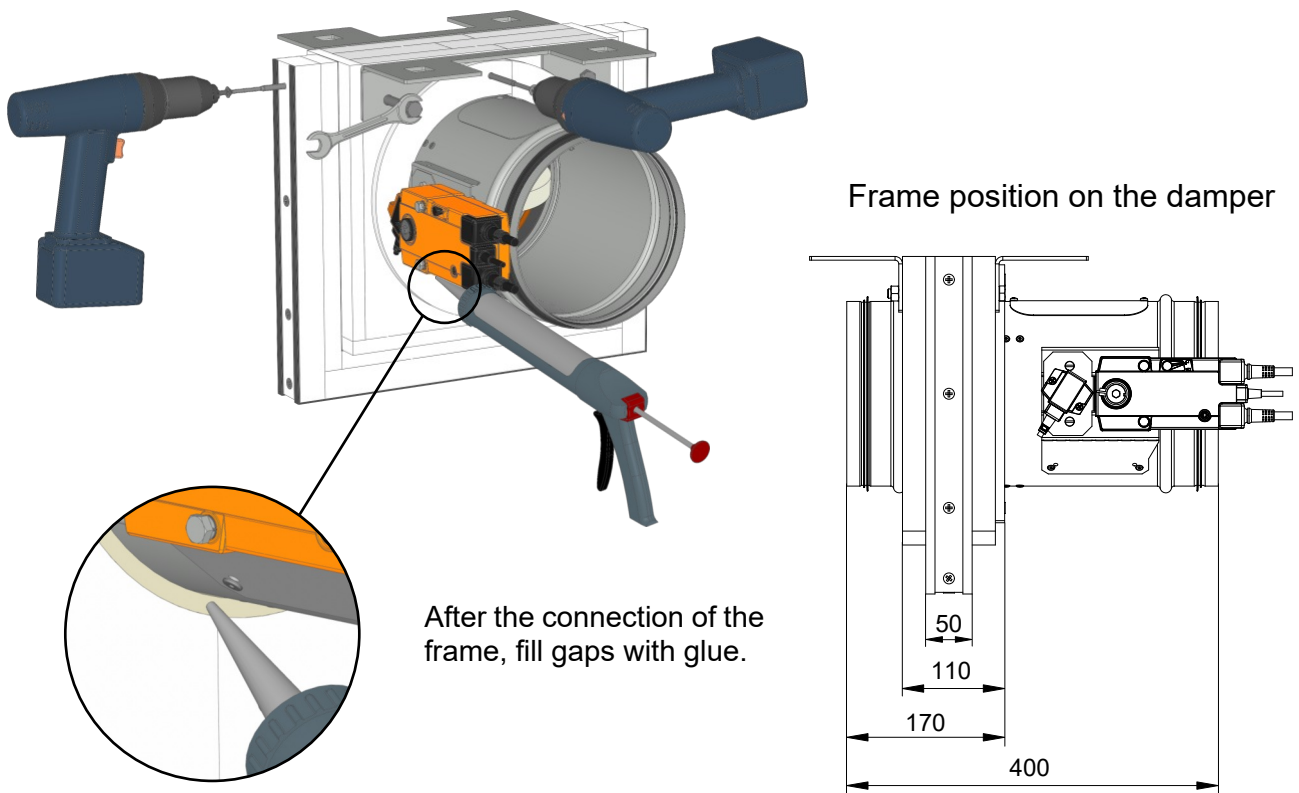

Note: The glue cures at 20°C after 12 hours. After this time, the fire damper with the mounting frame is ready for installation.

MANDÍK, a.s.
Dobříšská 550
26724 Hostomice
Czech Republic
Tel.: +420 311 706 706
E-Mail: mandik@mandik.cz
www.mandik.com

The producer reserves the right for innovations of the product. For actual product information see
www.mandik.com